

# VISION & DESIGN

## INSTALLATION MANUAL

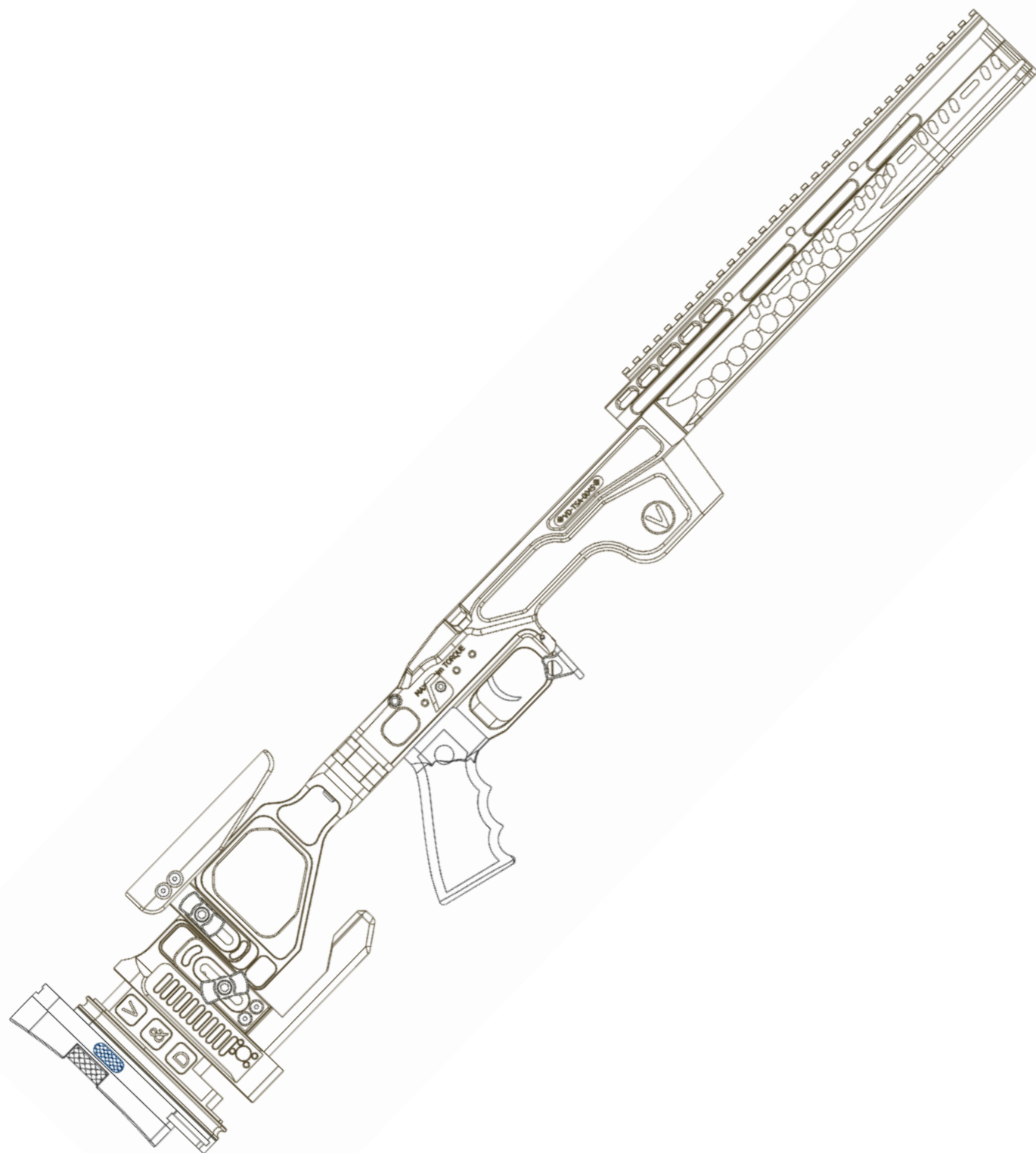

TIKKA/REMINGTON/TRG

# INFORMATION

Thank you for purchasing The Vision Chassis! We hope that you enjoy your chassis and we think that you'll find it to be of high quality and an exceptional value.

### **Safety warning:**



Before you attempt any installation, make sure your rifle is unloaded. Also, before starting, remove the bolt and magazine from the rifle.

# CONTENT

BILL OF MATERIALS					
ITEM	QTY	PART NUMBER	DESCRIPTION	KEYWORDS	ALLEN KEY
1	1	VDS-0002 M6 x 20	hexagon socket head cap screws	STOCK	5 mm
2	2	VDS-0009 M6 X 20	hexagon socket head cap screws	ACTION SCREWS SIG SAUER SSG 3000	5 mm
3	1	VDS-0010 M6 X 20	hexagon socket head cap screws	GRIP	5 mm
4	2	VDS-0008 1/4"-28 UNF	hexagon socket head cap screws	ACTION SCREWS REMINGTON 700 / CLONE	3/16
5	2	VDS-0007 M6 X 50	hexagon socket head cap screws	ACTION SCREWS TIKKA T3	5 mm
6	2	VDS-0001 M6 x 10	hexagon socket head cap screws	FRONT GUARD SCREWS	5 mm
7	1	VDS-0006 M4 x 5	Socket Flat Countersunk Head Cap Screws	THUMB REST SCREW	2,5 mm
8	4	VDS-0004 M4x10	Socket Flat Countersunk Head Cap Screws	FOLDER / EXTENTION MID SECTION TO STOCK	2,5 mm
9	3	VDS-0005 M4x6	Socket Flat Countersunk Head Cap Screws	BIDER PLATE FRONT GUARD/MID SECTION	2,5 mm
10	6	VDS-0003 M3 x 12	hexagon socket head cap screws	PICATINNY/FLAT TOP SCREWS	2,5 mm
11	1	VDBP-0001		BINDER PLATE	
12	1	VDAD-0001		ADAPTER BETWEEN STOCK AND MID	
13	1	VDGR-0001		FAB DEFENSE GRIP	
14	1	VDTR-0001R		THUMB REST	

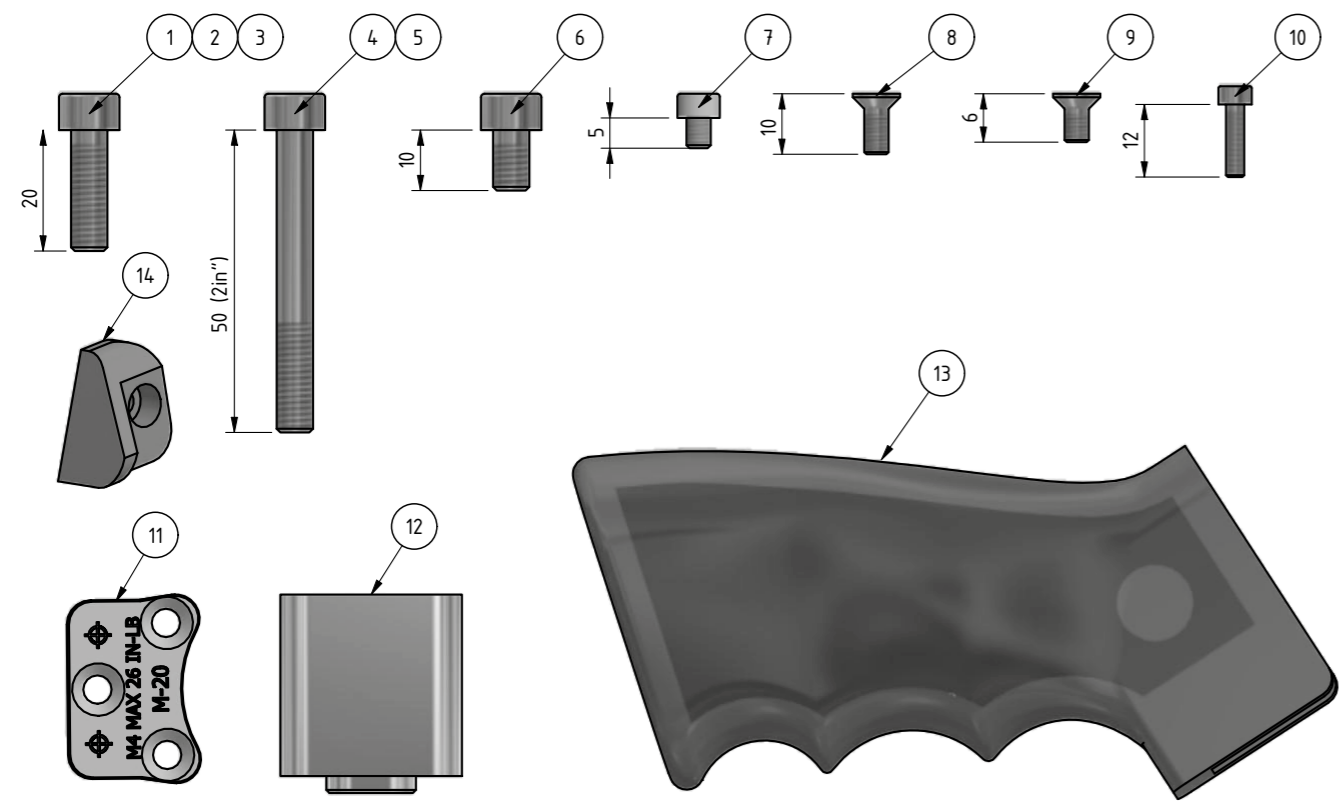

# ASSEMBLING

## STEP 1:

Put the M4 x 10mm screws in the holes in adapter between stock and mid section and place it on the back of the mid section, then screw in the screws.

## STEP 2:

Place the stock on to the adapter between stock and mid section and screw in the M6 x 20mm screw, tighten until the stock sits solid.

**CAREFULL** when tightening the screw so it doesn't slip and damage the coating.

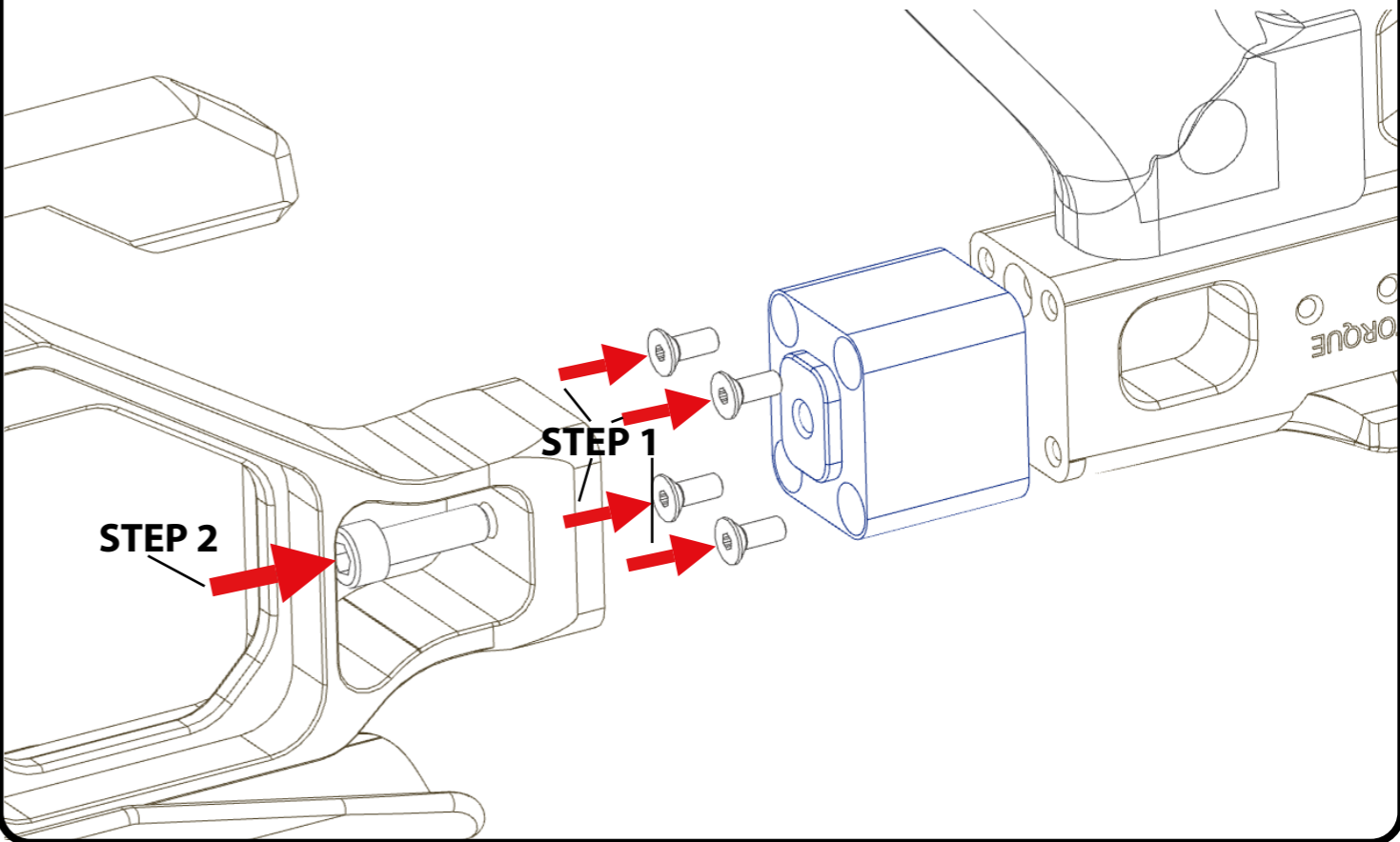

# ASSEMBLING

## STEP 3:

Place front guard on the middle part and screw in the M6 x 10mm screws, tighten to 70 in-LB (7Nm) torque max.

## STEP 4:

Place the binder plate in position and screw in the M4 x 6mm screws, tighten to 26 in-LB (2,6Nm) torque max.

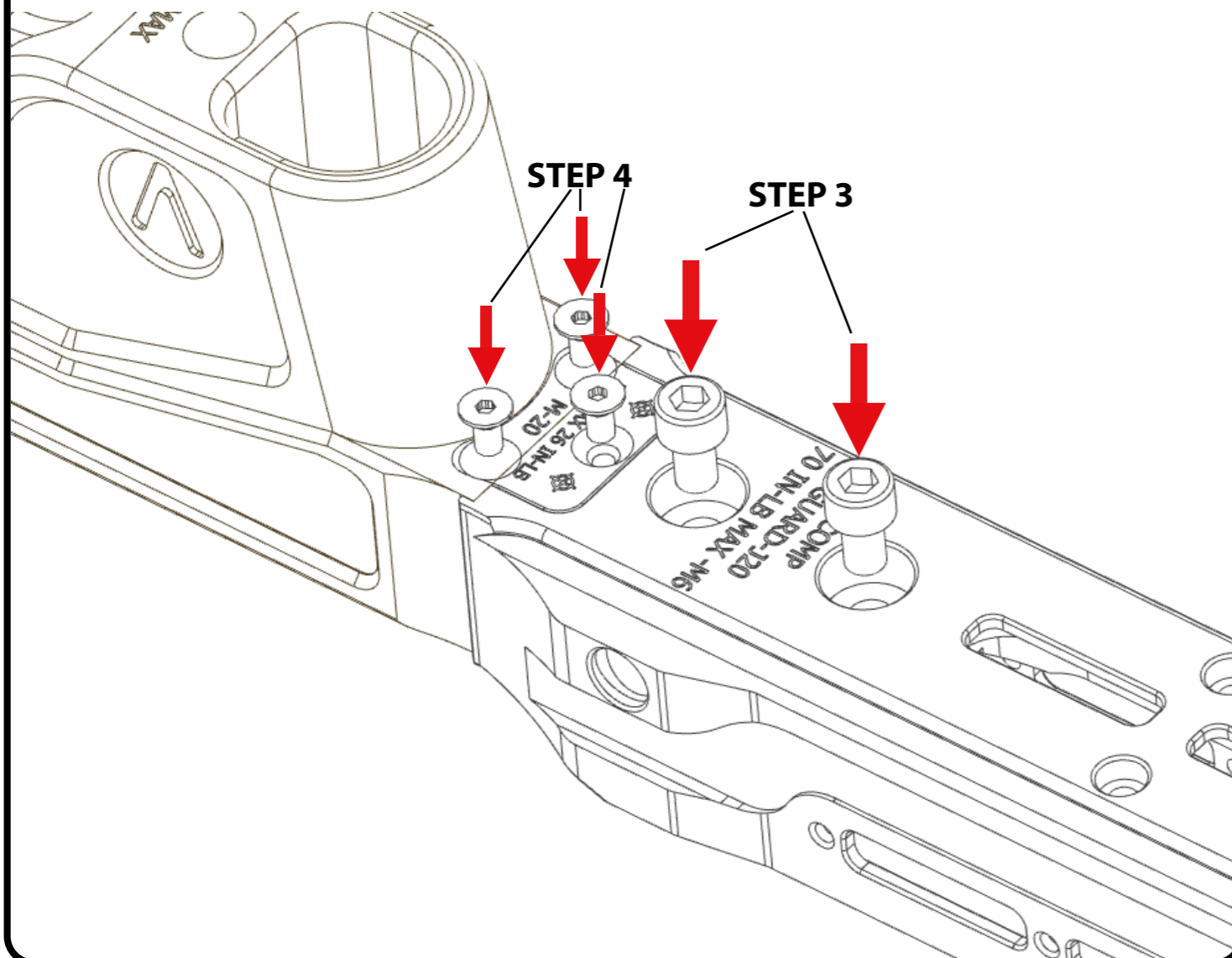

# ASSEMBLING

## STEP 5:

Place the action in chassis and make sure the recoil lug sits properly (tikka t3) in the recoil lug slot on the action.

## STEP 6:

Screw in the M6 x 50mm screws, tighten to 70 in-LB (7Nm) torque max.

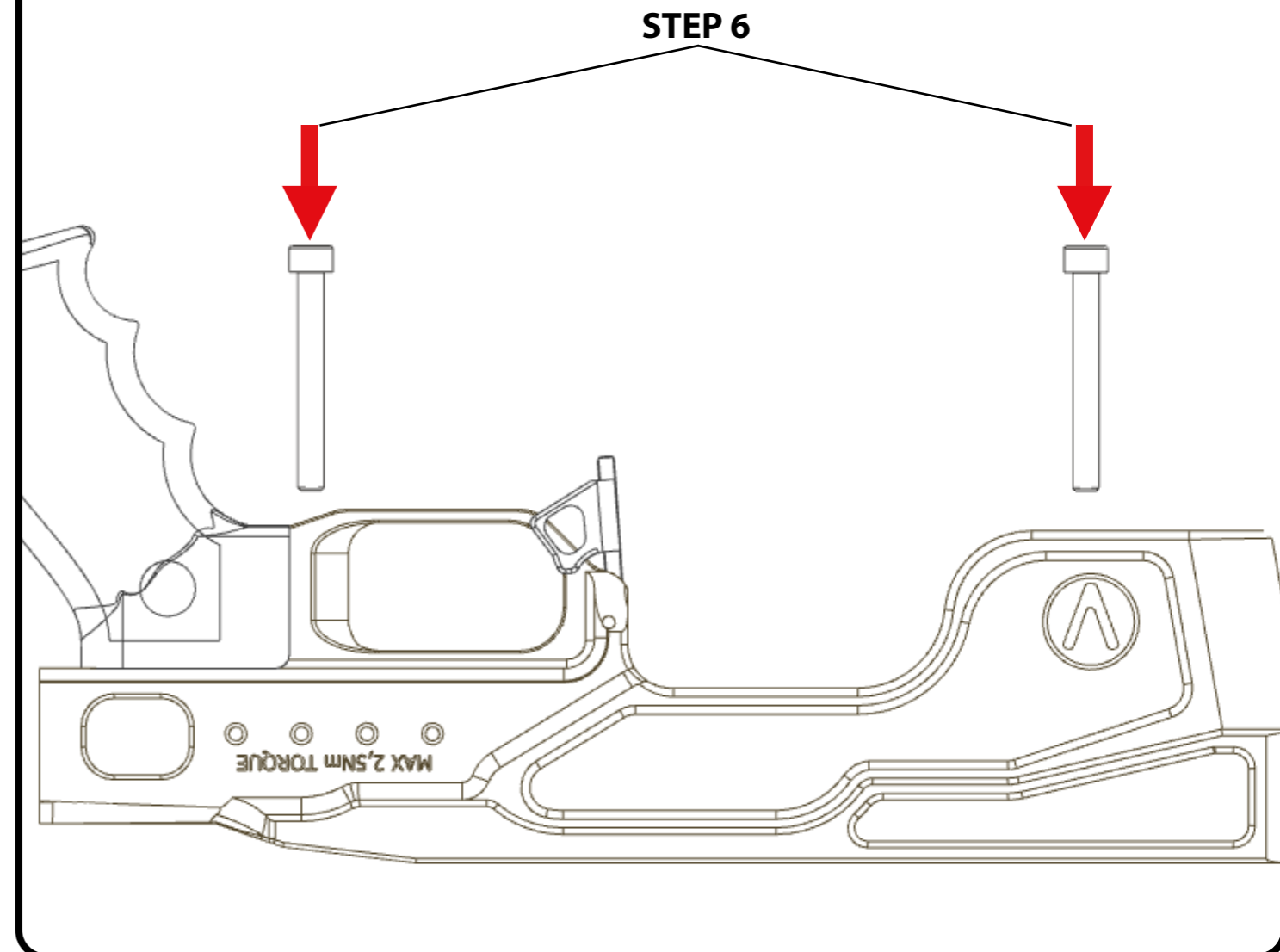

# ASSEMBLING

## STEP 7:

Place the top cover on to the front and screw in the M3 x 12mm screws, tighten to 8 in-LB (0,9Nm) torque max

If all steps are followed you are ready to go

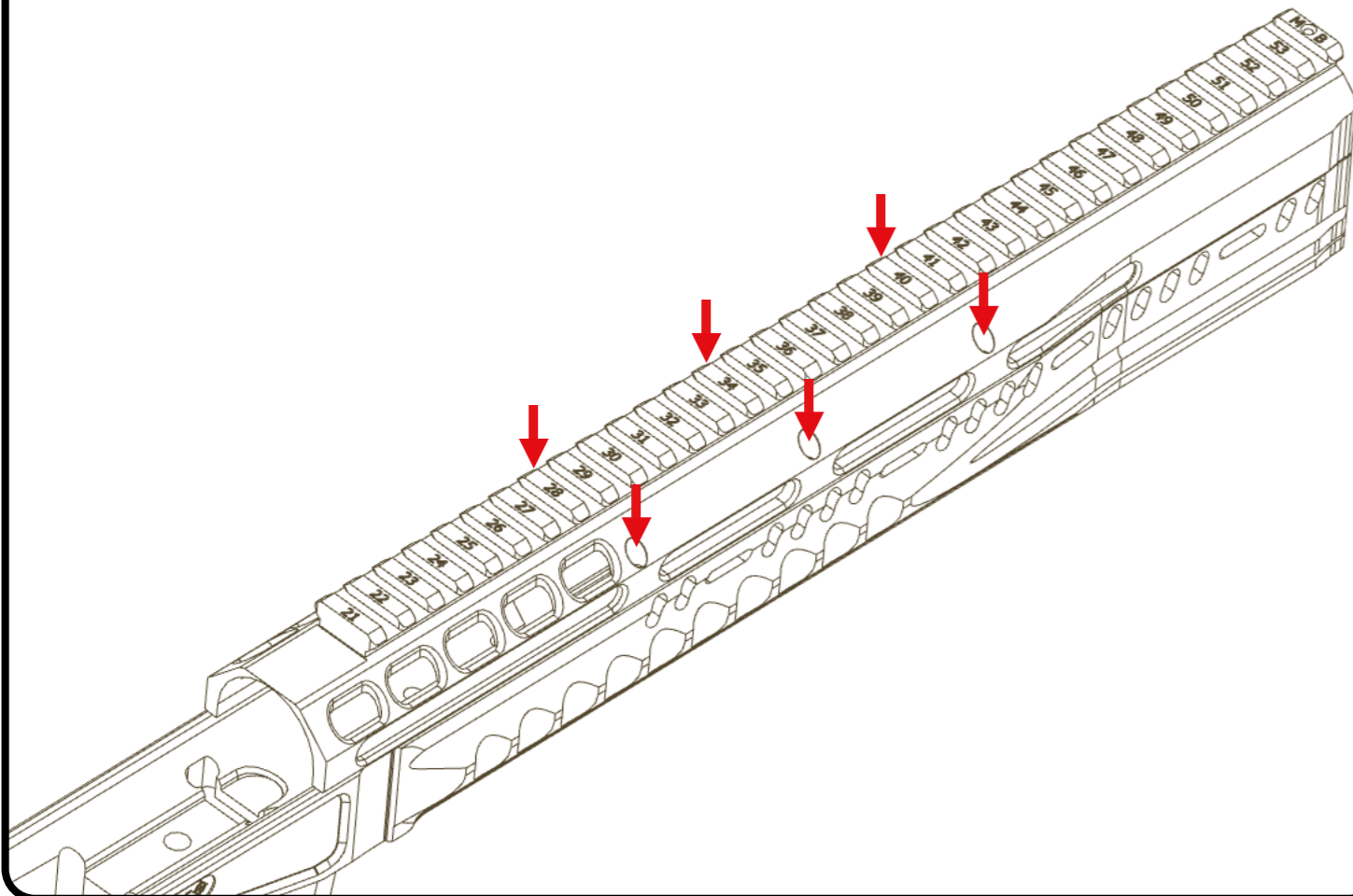

# STOCK ADJUSTMENTS

## A. Cheek rest:

Loosen wingnut, adjust cheek by pulling upwards, then tighten the wingnut.

## B. Butt plate hight:

Press the blue button to unlock butt plate and adjust.

## C. Bag rider:

Loosen wingnut, adjust bag rider by pulling it down, then tighten the wingnut.

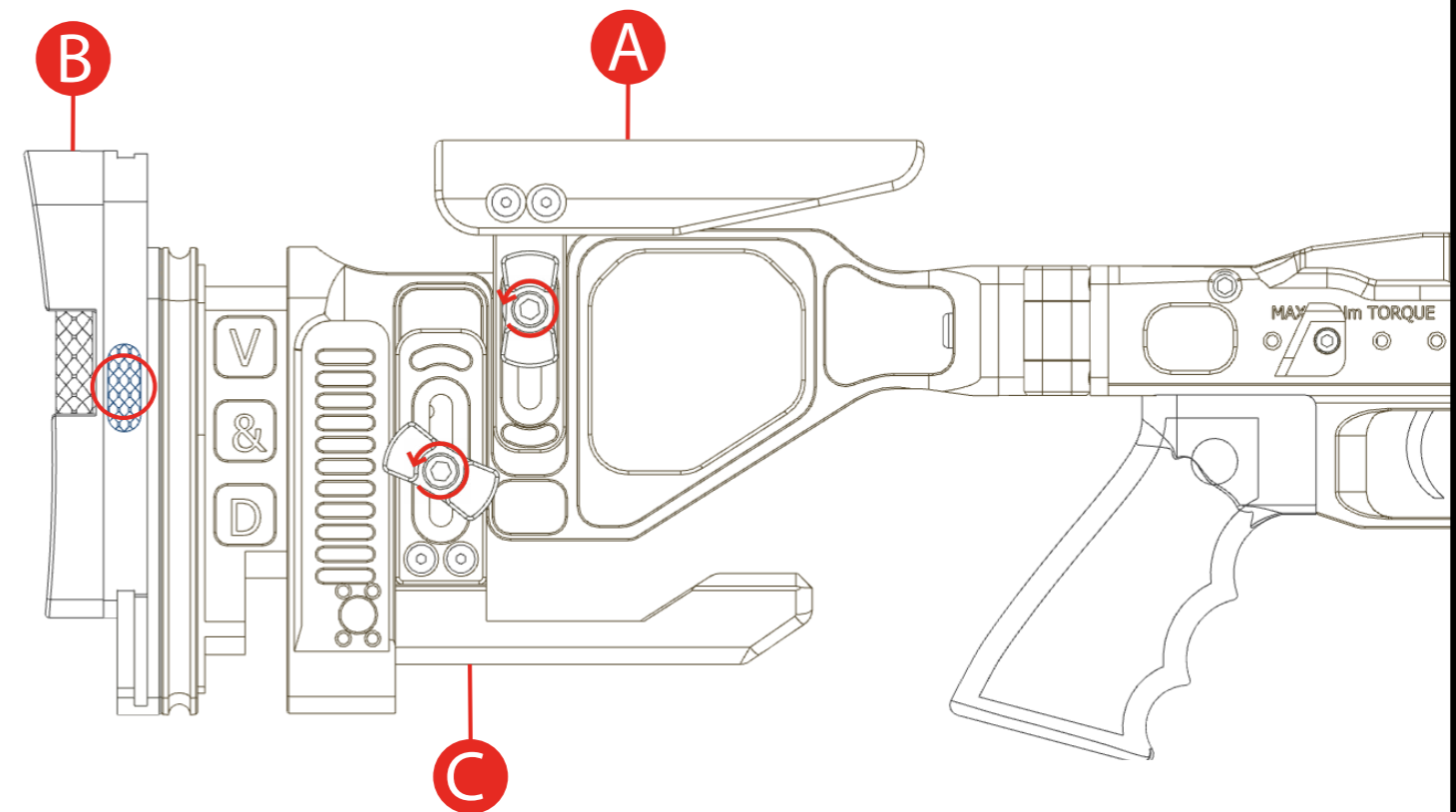

# STOCK ADJUSTMENTS

## D. Cant:

To adjust cant, loosen the wheel and place in desired location, then tighten the wheel.

## E. Length of pull:

To adjust length of stock, loosen the bolt, place bolt in new placement, then tighten the bolt.

## F. Shims:

For more length, remove butt plate and stack multiple shims.

